

A B C D E F G H J K L M N P Q R S T U V W X Y Z

A3 1 2 3 4 5 6 7 8 9 10 11 12 13 14 15 16 17 18

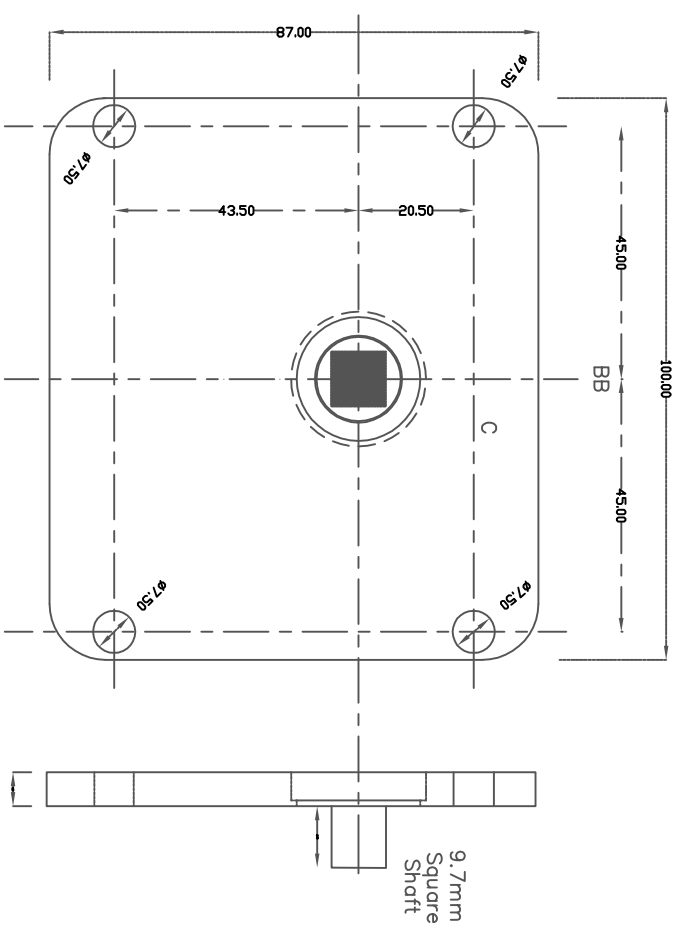
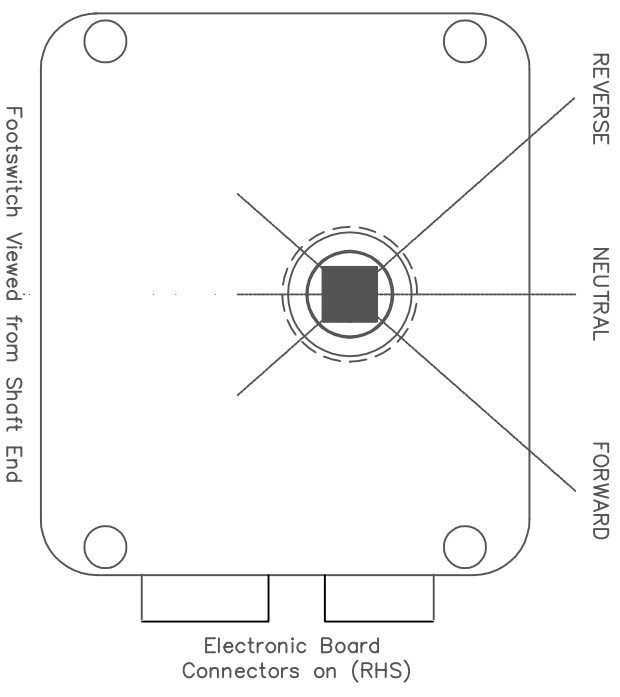

Note Footswitch Depth is 115mm from the front of the mounting plate.

REV	Details	Date
0	Original Issue	DEC 08
1	General Revision	Feb 09



38 Hamilton Street
 DAPTO NSW 2530
 Ph 02 42622572
 Fax 02 42621212
 Email sdies@krs-design.com

KRS Intelligent Footswitch Control		SHT No
CHECKED	DATE	0
APPROVED	DRAWN	REV No
KAS	KAS	1
EE907-12		

A B C D E F G H J K L M N P Q R S T U V W X Y Z